

NOČNÍ STOLEK č.F132

500x502x330

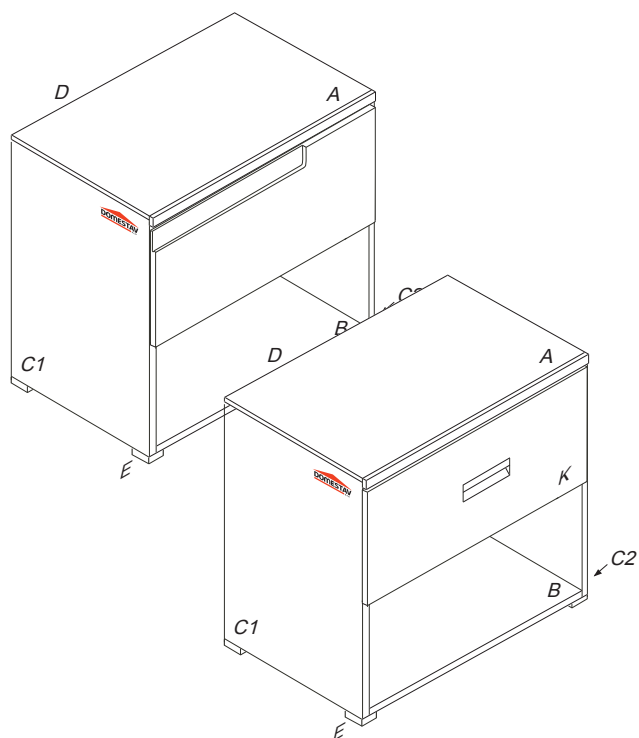

Kolíky vždy narazte nejprve do otvorů ve hranách dílců, je nutné je zarazit se stejným přesahem. V případě, že některý kolík přesahuje, je nutné jej zakrátit. Dílce srážejte kladivem pouze přes dřevěnou podložku.

1/3

	3 x1	4 x1	6 x24	43 x4	22 x4	60 x18
	3mm	4mm	8x35mm	EU 6x16mm	3,5x16mm	15mm
		61 x18	70 x12	80 x1	92 x50	120 x4
		DU 2	5x40mm	300mm	1,4x20mm	filc

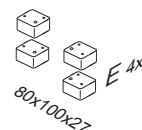
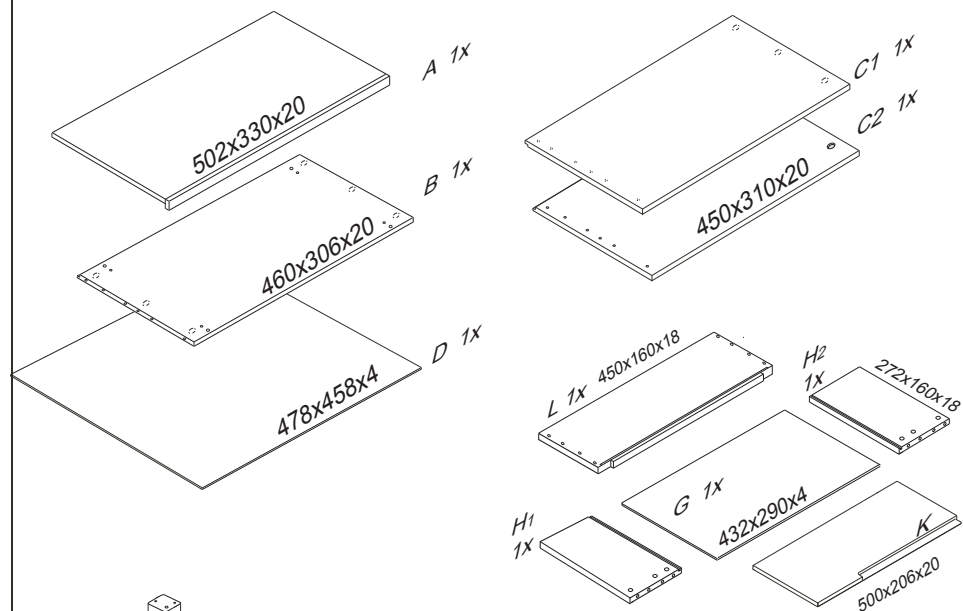

F132

1

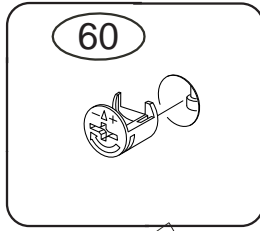

2

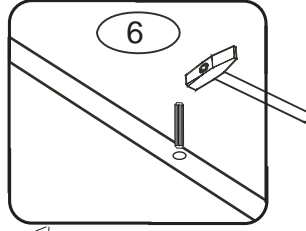

3

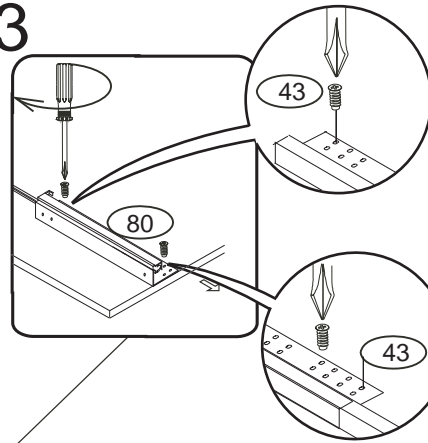

4

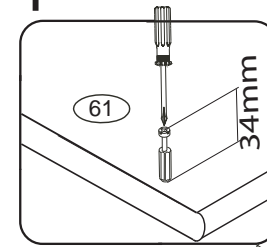

5

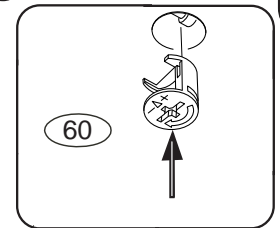

2/3

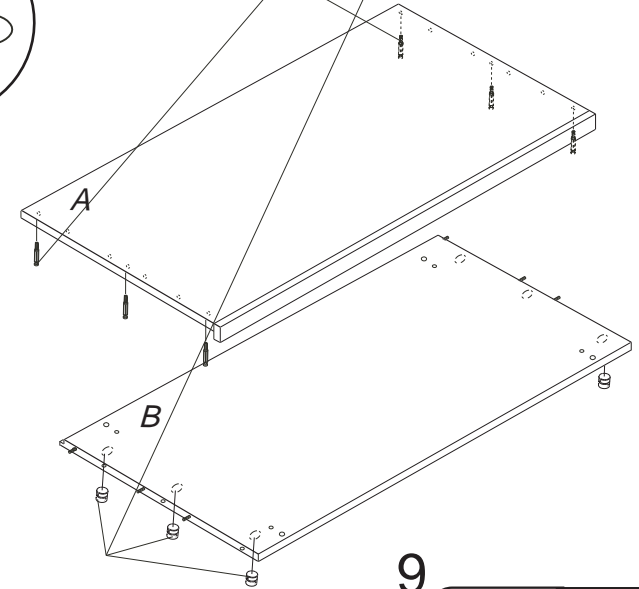
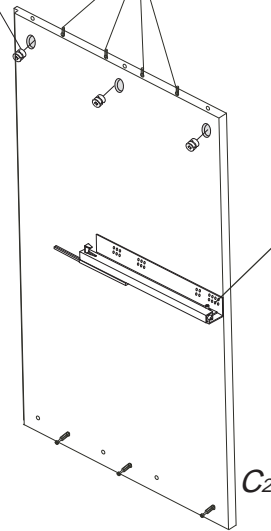
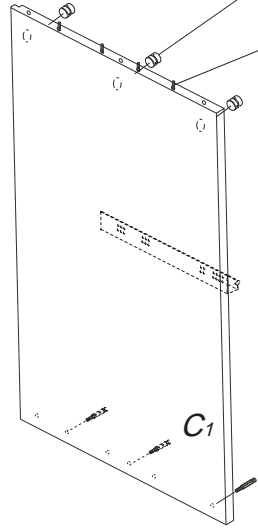

6

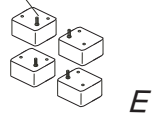
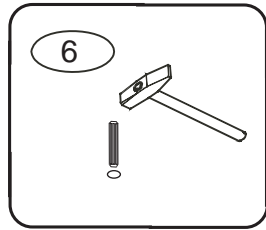

8

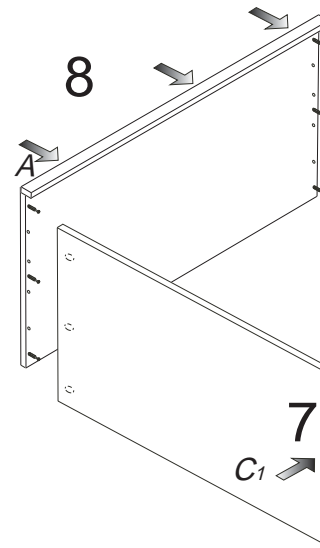

C2

7

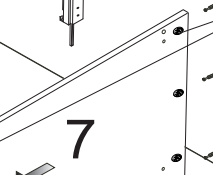

7

C1

9

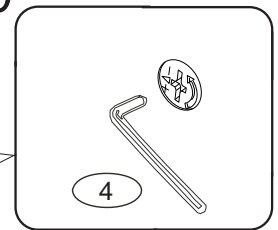

F132

3/3

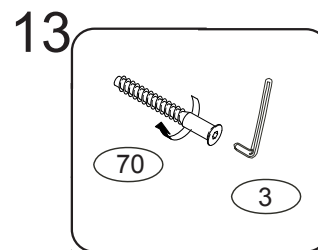
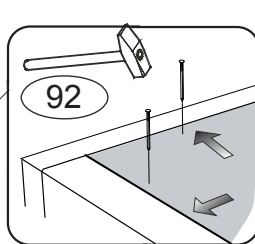
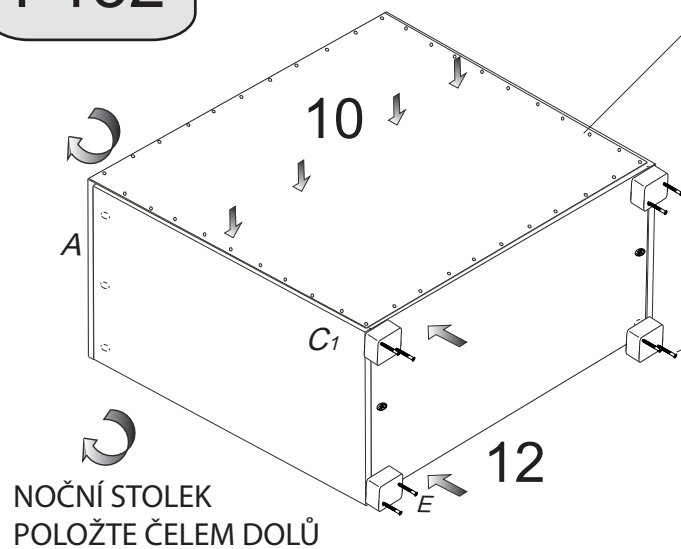

ZÁSUVKU
POLOŽTE DNEM NAHORU

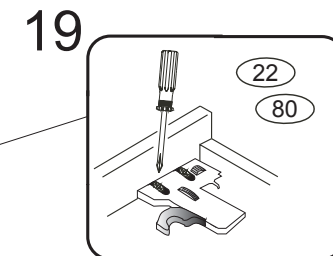

Pro případ nebezpečí, že by stolek
přepadával vpřed, je možné nožku
přemontovat do předsunuté pozice.

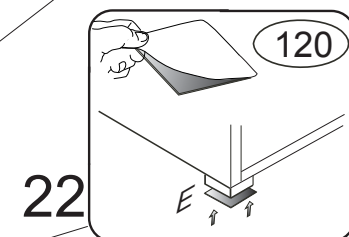
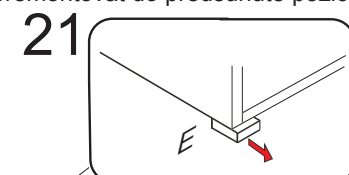
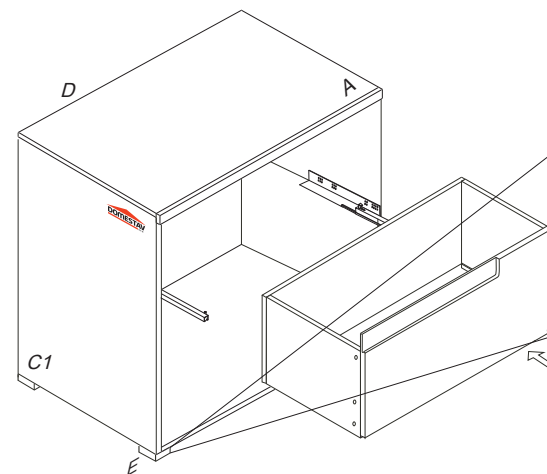
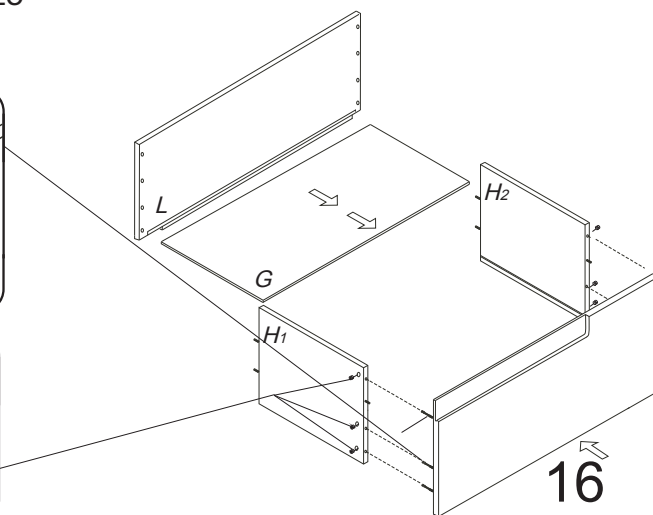
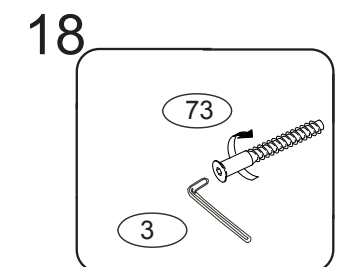
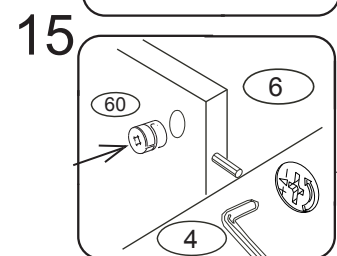
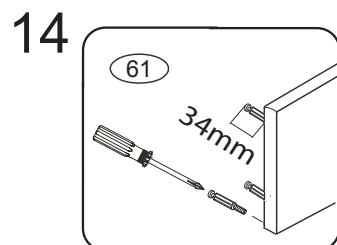

Na vysunuté pojizdy
nasadte zásuvky.
Polohu zásuvek upravte
červeným kolečkem na spojce.

