

Skříň šatní

F153

802x600x2197

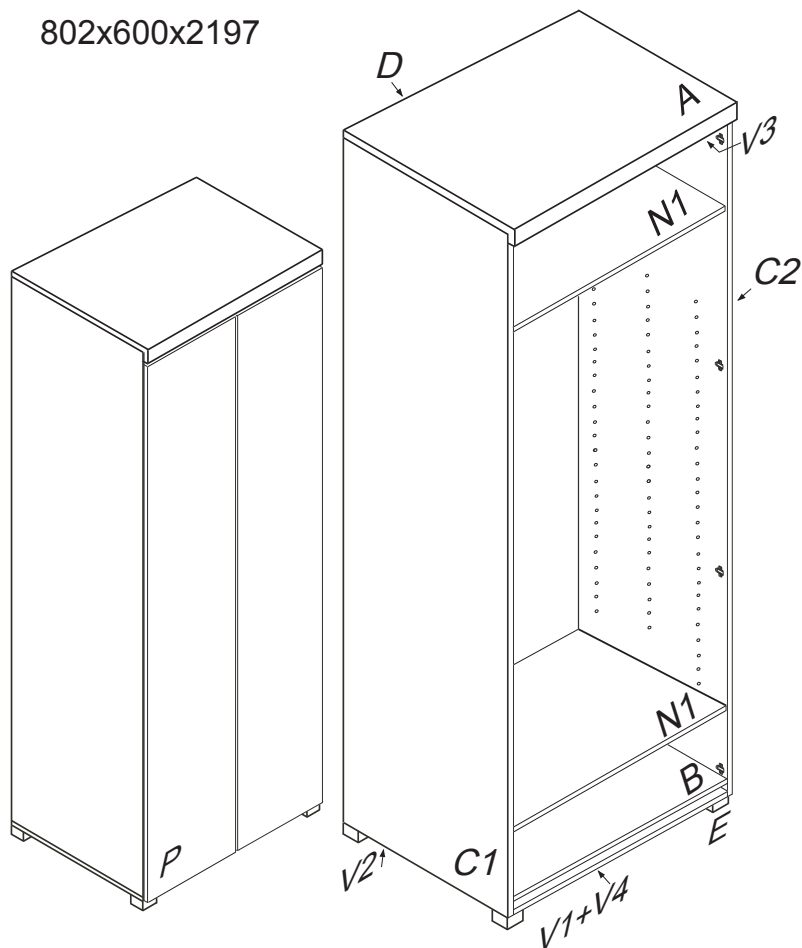

Kolíky vždy narazte nejprve do otvorů ve hranách dílců, je nutné je zarazit se stejným přesahem. V případě, že některý kolík přesahuje, je nutné jej zakrátit. Dílce srážejte kladivem pouze přes dřevěnou podložku.

1/7

	3 x1	4 x1	6 x46	22 x42		
43 x8	60 x35	61 x35	67 x8	70 x8	75 x4	76 x4
89 x2	92 x50	120 x4			130 x4	131 x1
					wing line 770	wing line 770

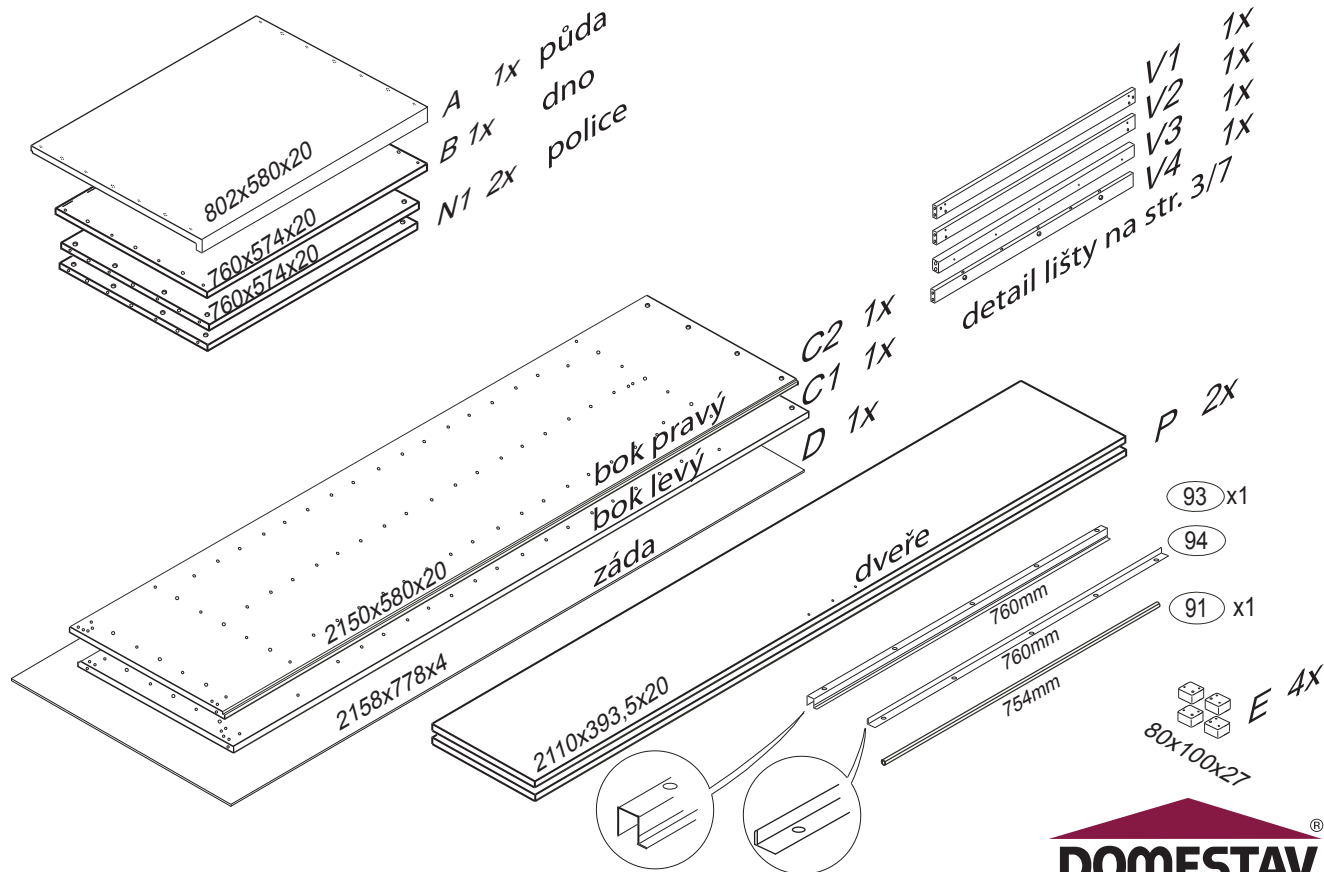

F153

1

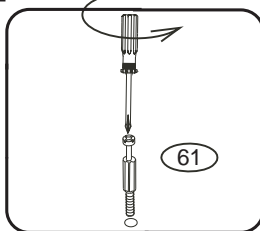

2

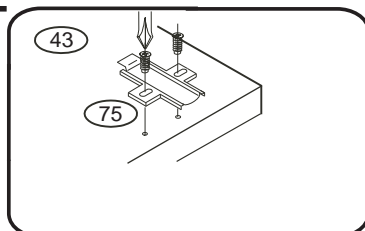

3

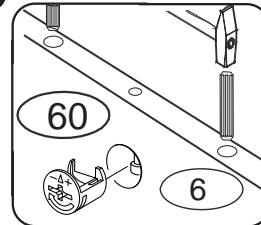

4

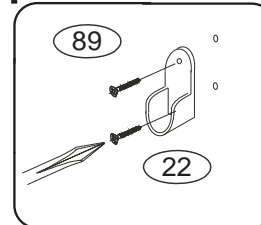

2/7

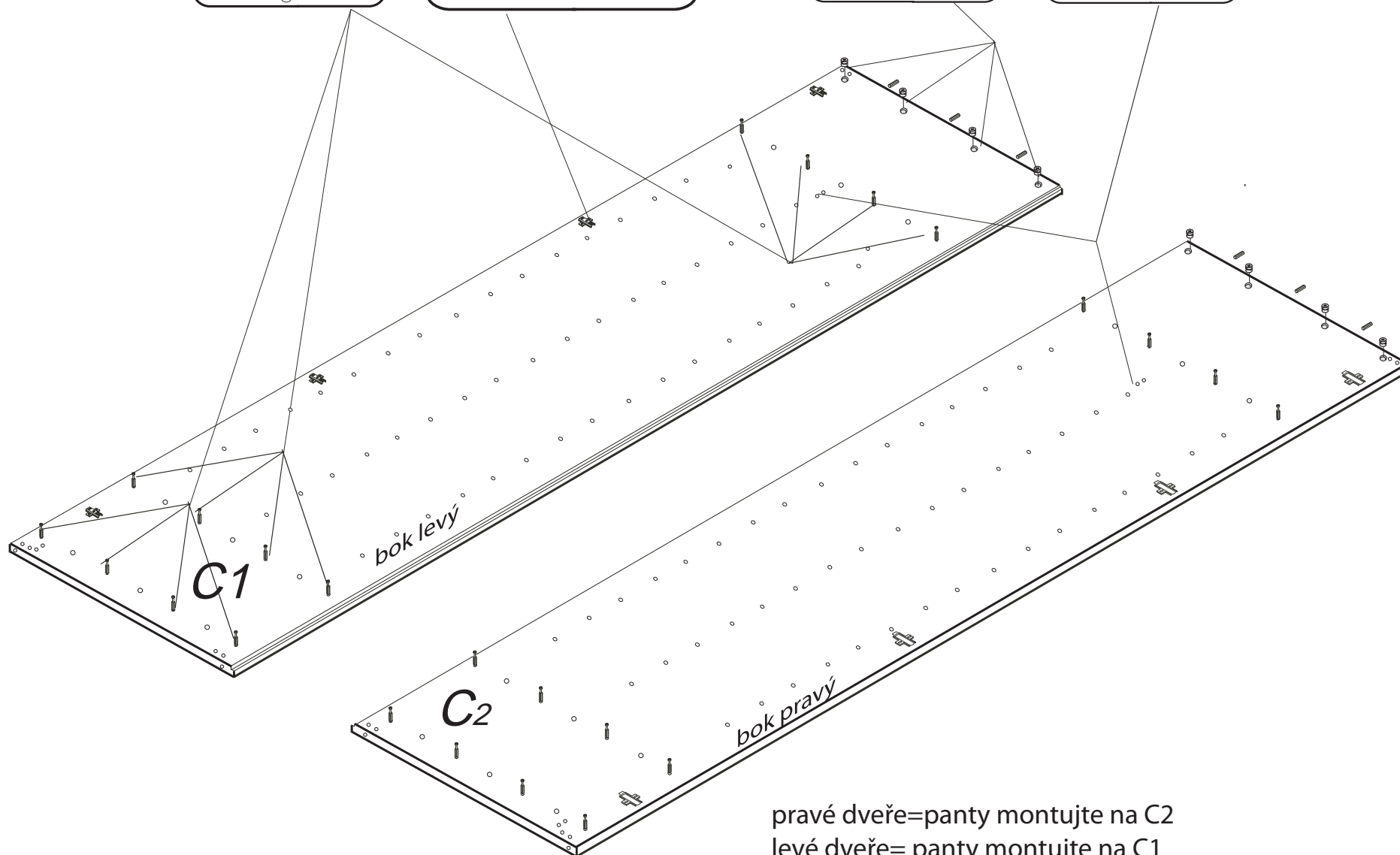

pravé dveře=panty montujte na C2
levé dveře= panty montujte na C1

F153

5

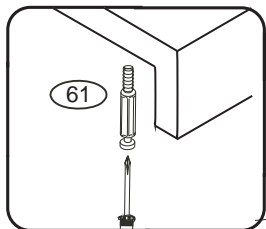

6

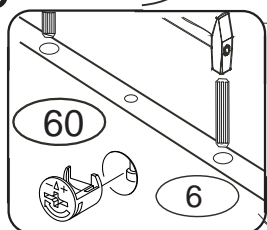

7

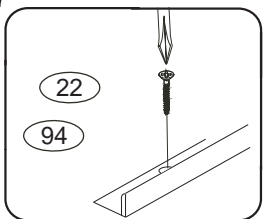

8

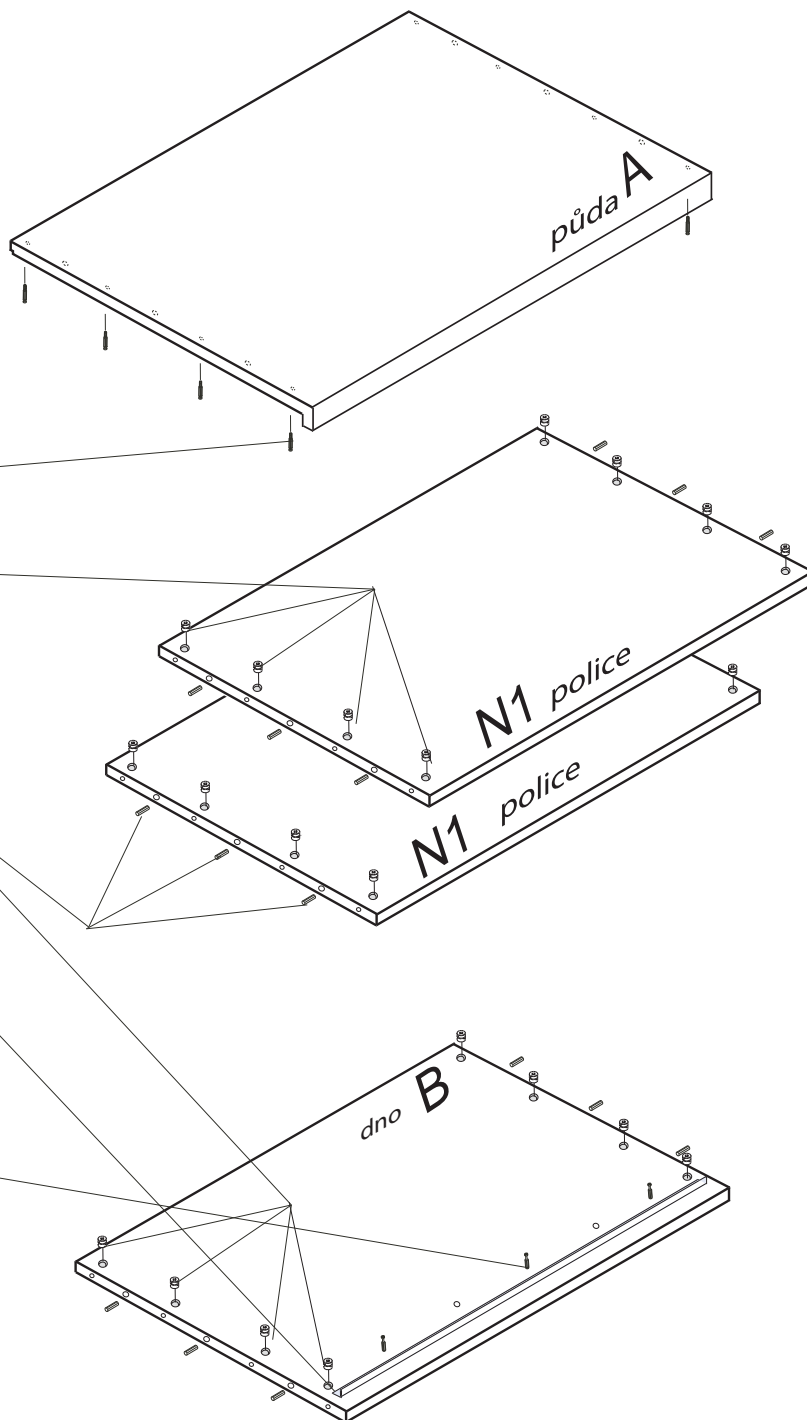
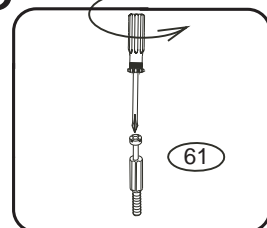

9

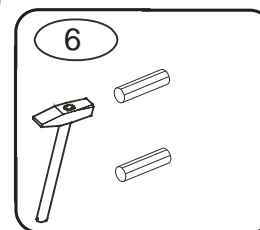

10

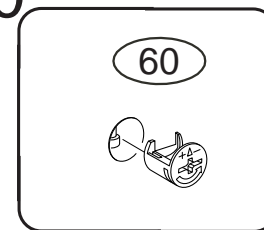

3/7

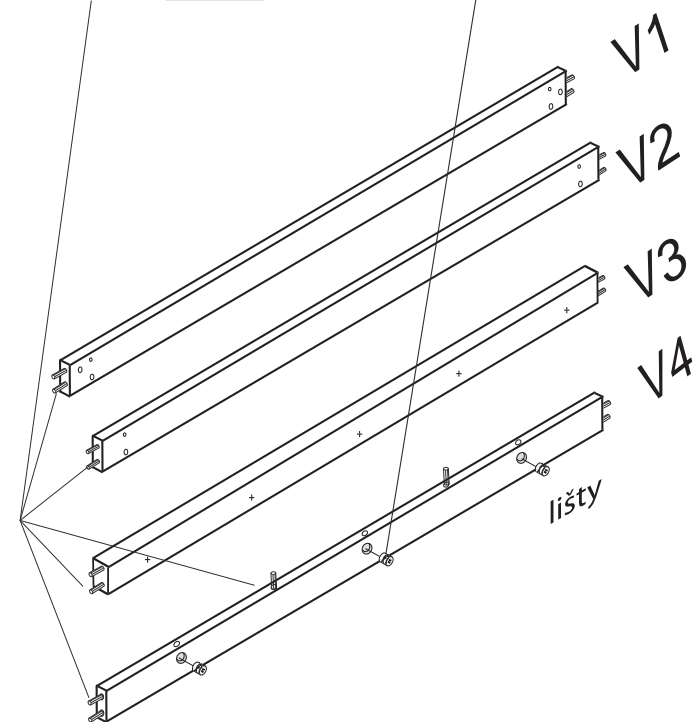

11

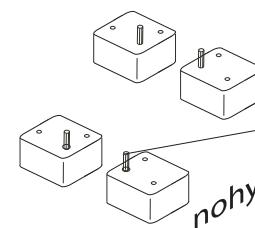

nohy

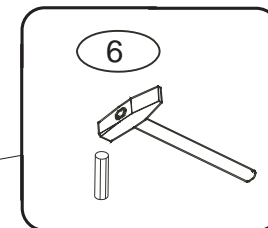

F153

13

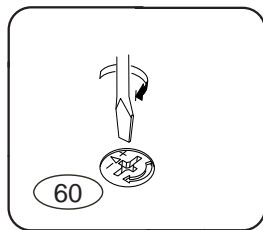

15

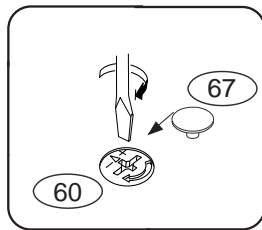

4/7

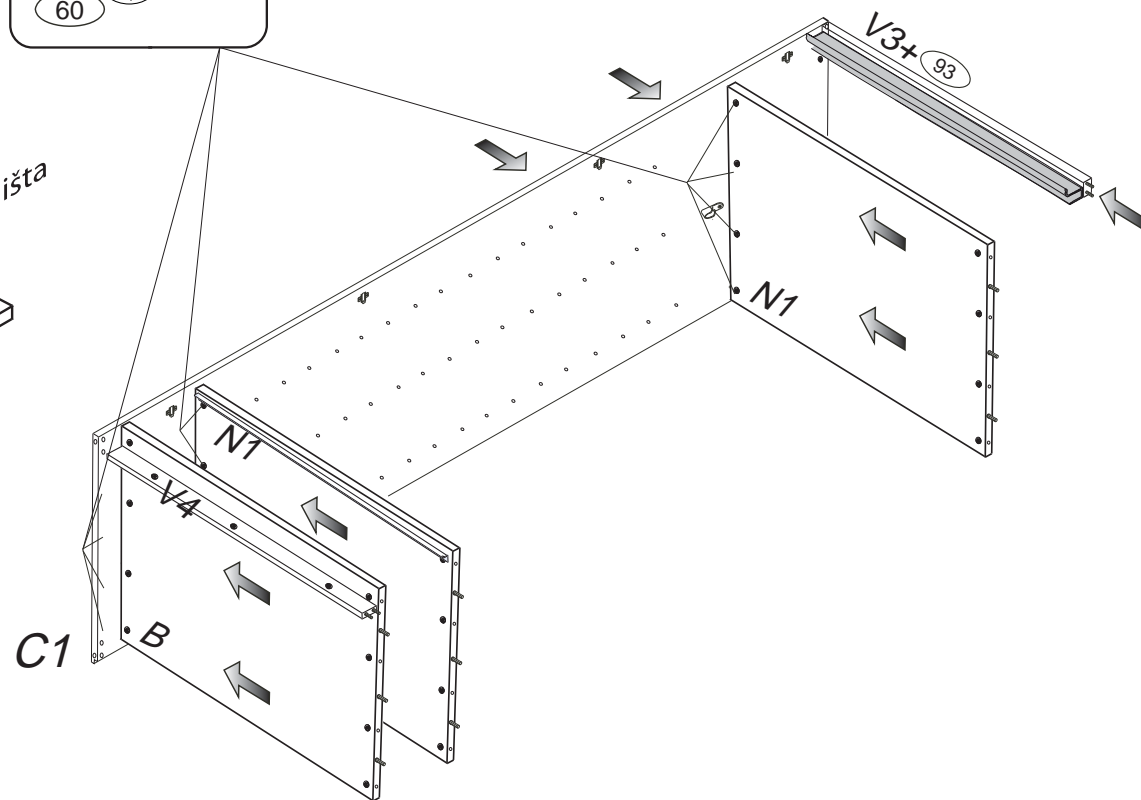
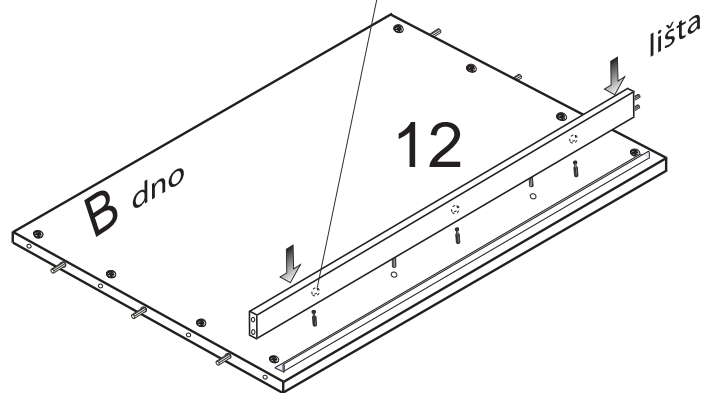

14

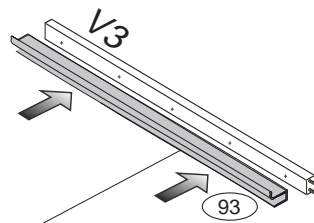
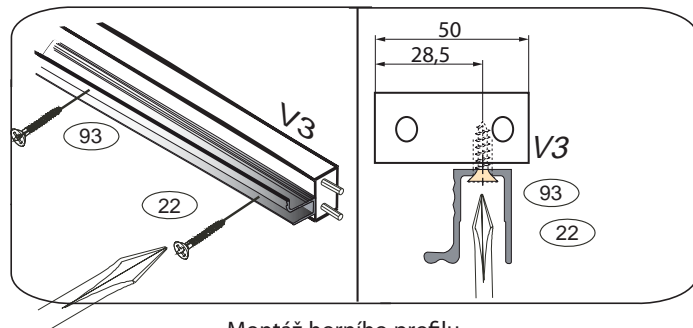

F153

20

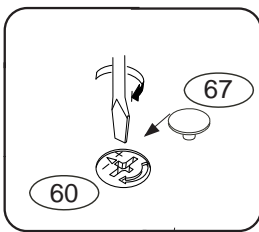

V3+ 93

19
A

C1 N1

16

B

17

V4

18

C2

91

D

21

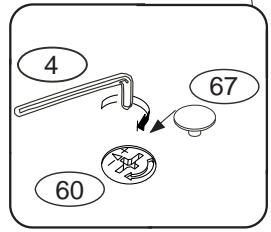

22

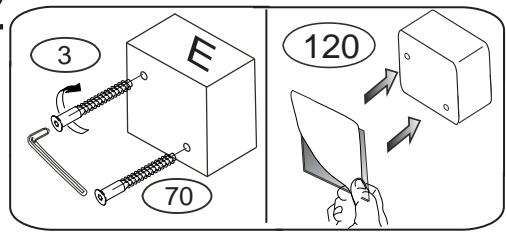

5/7

23

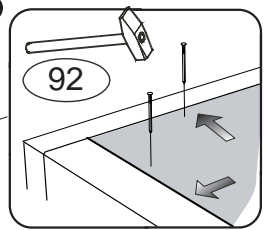

24

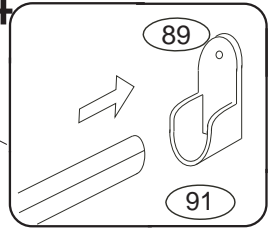

F153

MONTÁŽ KOVÁNÍ WING LINE 770

25

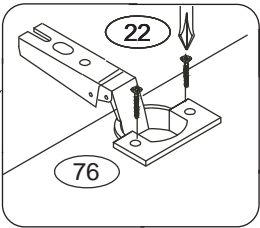

Příprava dveří

6/7

27

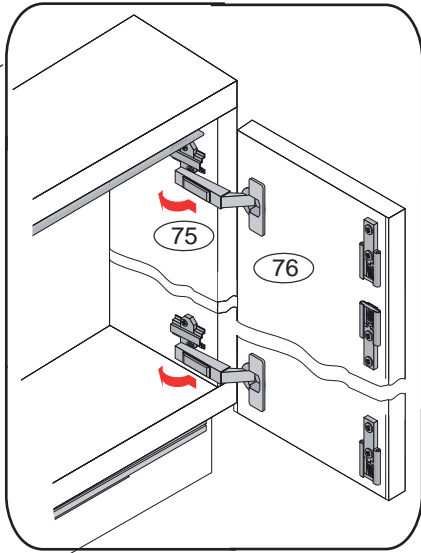

Upravte polohu dveří

28

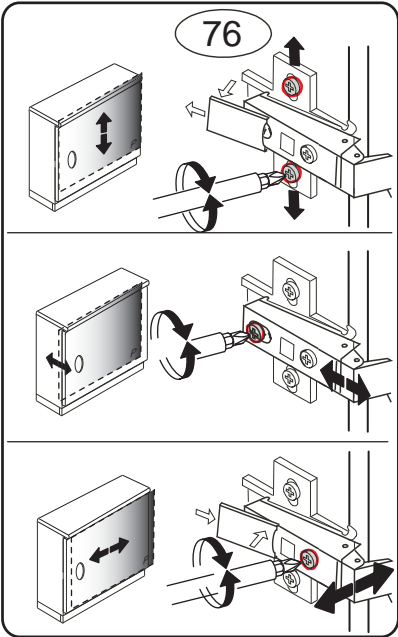

26

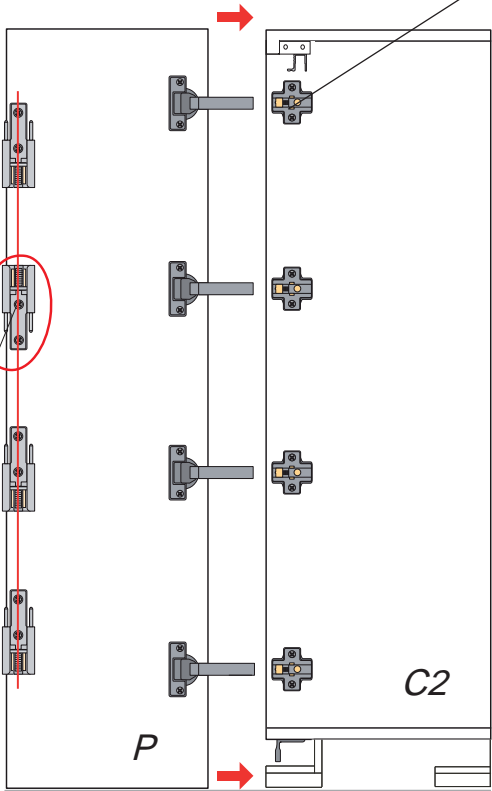
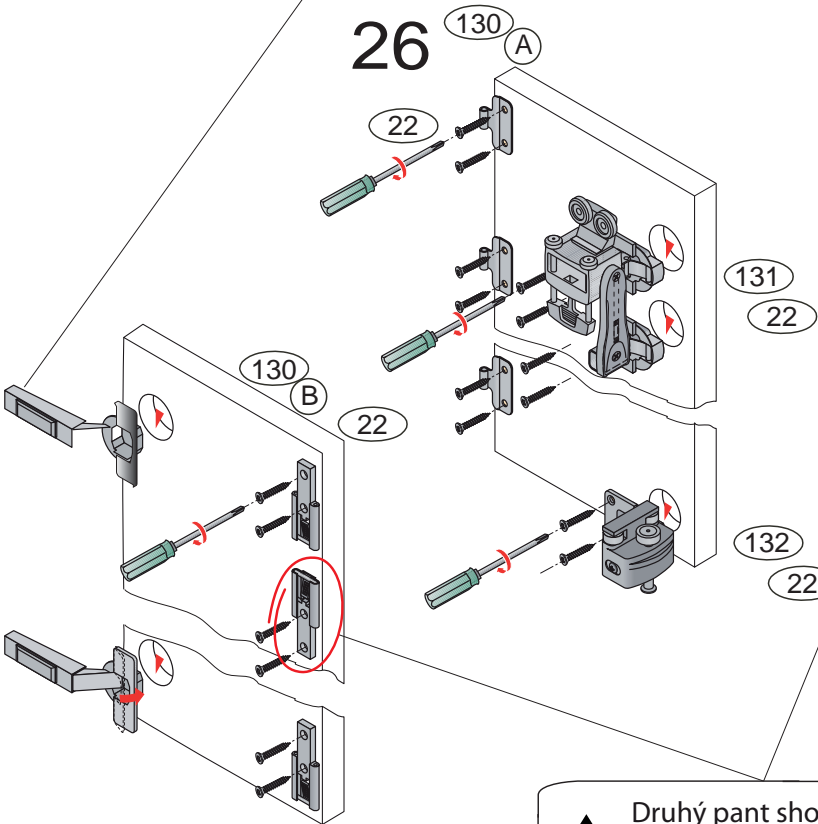

Druhý pant shora při montáži otočte o 180°.
Zajišťuje dveře proti vypadávání.

C2

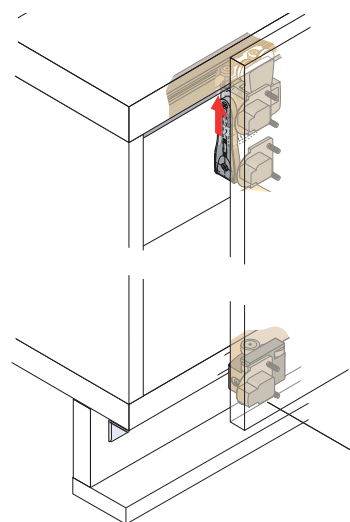
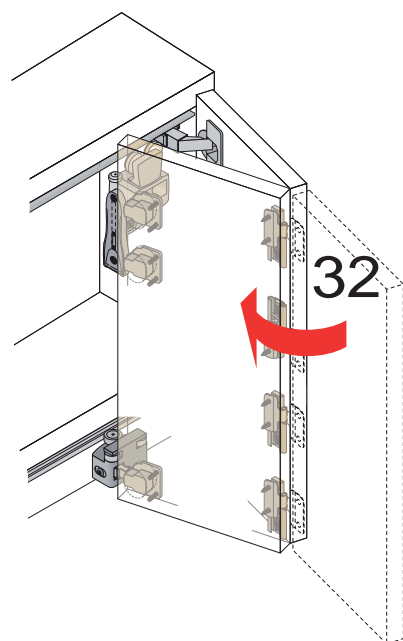
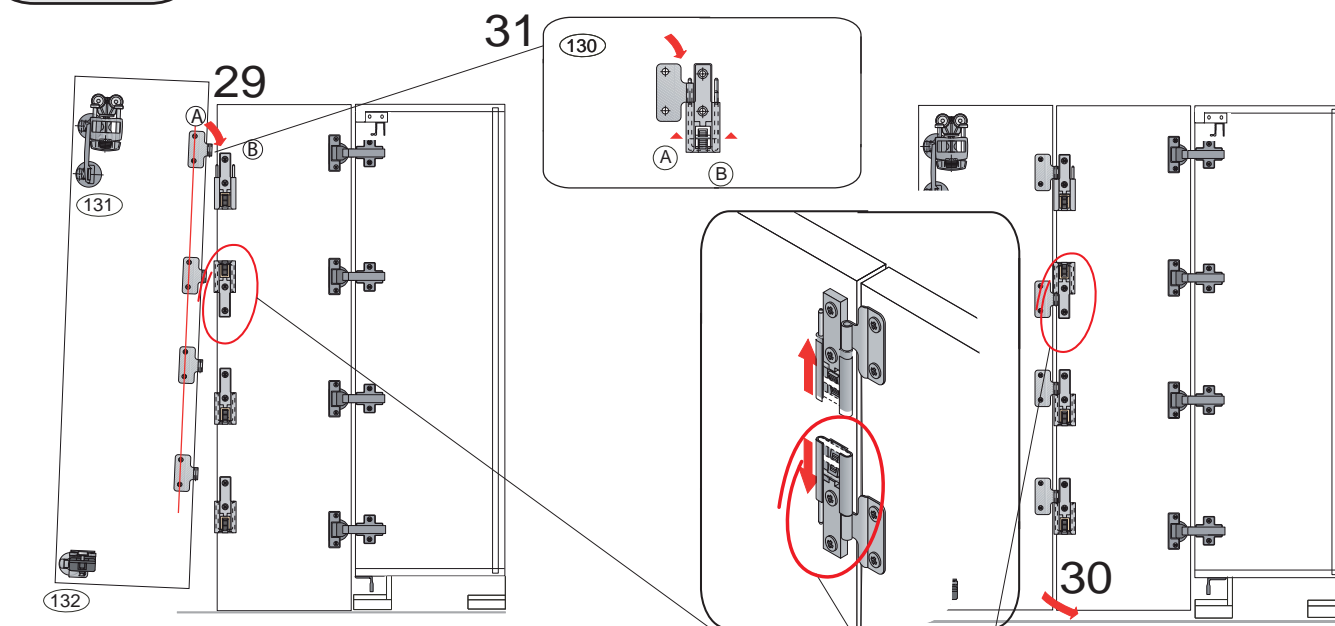

! Druhý pant shora je namontován opačně.
Zajišťuje dveře proti vypadávání.

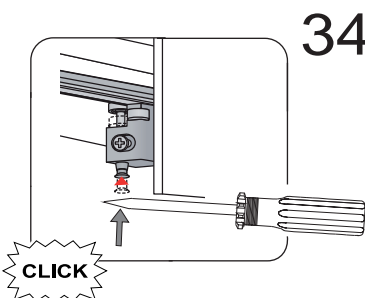

35
Upravte polohu dveří

